

# Large-area vacuum gripping systems FXC/FMC

## Product specifications of FXC/FMC with suction pads

### Technical data of large-area vacuum gripping systems FXC/FMC with suction pads

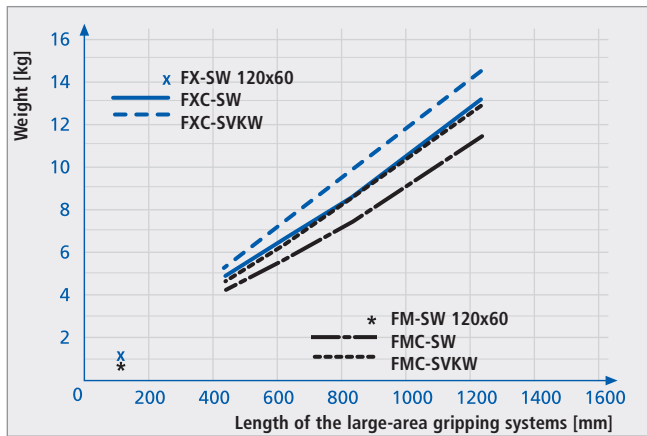

Weight of the large-area vacuum gripping systems (Types FXC-SW and FMC-SW with suction pads FG20 are lighter)

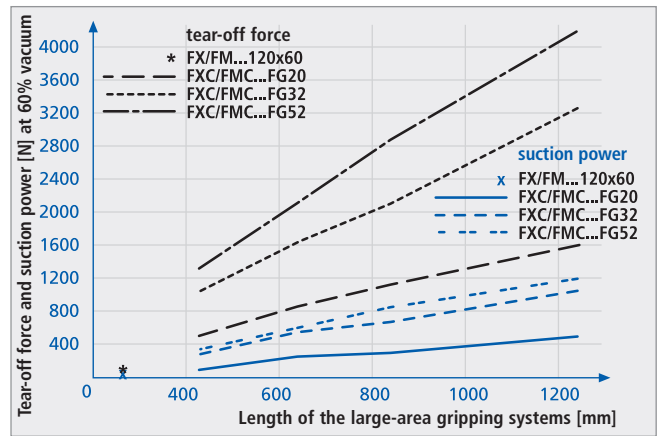

Tear-off force and suction power [N] at 60% vacuum and full coverage of the large-area vacuum gripping systems holding a rigid workpiece

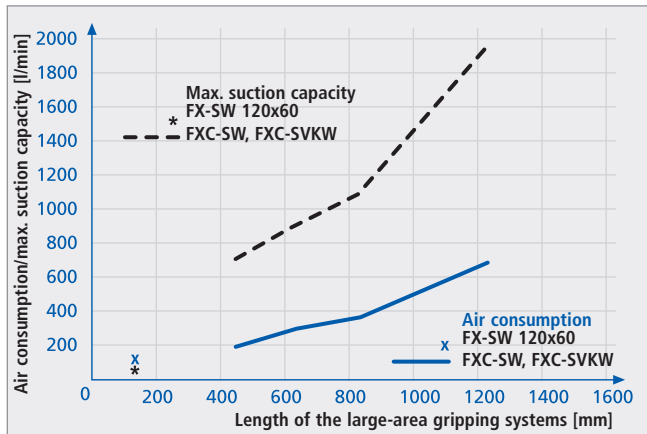

Air consumption and suction capacity of the large-area vacuum gripping system FX/FXC (FM/FMC can not be represented due to the external vacuum generator)

Type	Noise level [db (A)]	Max. evacuation level [%]
FXC	65	80
FMC	-*	-*

\*FMC can not be represented due to the external vacuum generation

### Construction data of the large-area vacuum gripping systems FX/FM with suction pads

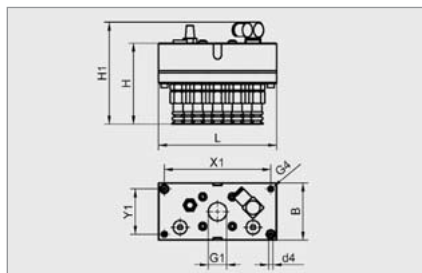

FX-SG 120x60

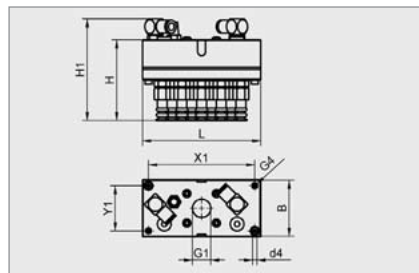

FX-SG 120x60 SEA

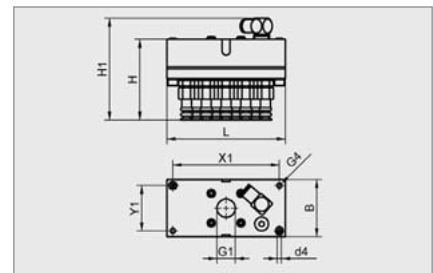

FM-SG 120x60

Type	Dimensions [mm]									
	B	d4	G1	G4	H*	H1	L	X1	Y1	N***
FX-SW 120x60 20 FG12	60	4.5	G1/2"-IG	M6-IG	82	103	120	108	46	14
FX-SW 120x60 20 FG12 SEA**	60	4.5	G1/2"-IG	M6-IG	82	103	120	108	46	14
FM-SW 120x60 20 FG12	60	4.5	G1/2"-IG	M6-IG	82	103	120	108	46	14

\*Other types of suction pads (design, material) on request

\*\*Gripping systems with integrated blow-off piston for quick lowering of the workpiece

\*\*\*Number of suction pads

Note: Type FX requires compressed-air hose 8/6mm, type FM requires vacuum hose 8/6mm.

# Large-area vacuum gripping systems FXC/FMC

## Product specifications of FXC/FMC with suction pads

### Construction data of the large-area vacuum gripping systems FXC/FMC with suction pads

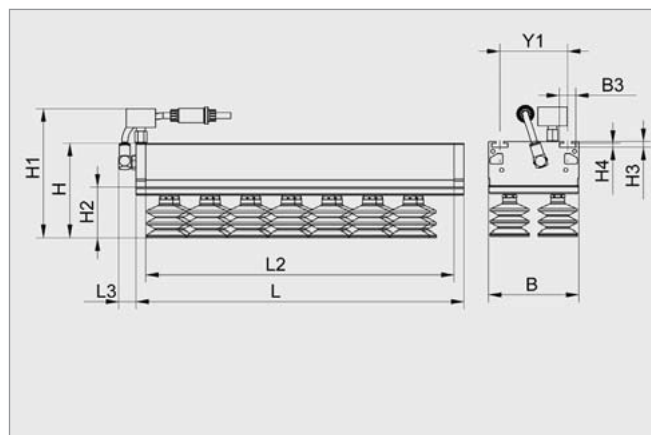

FXC

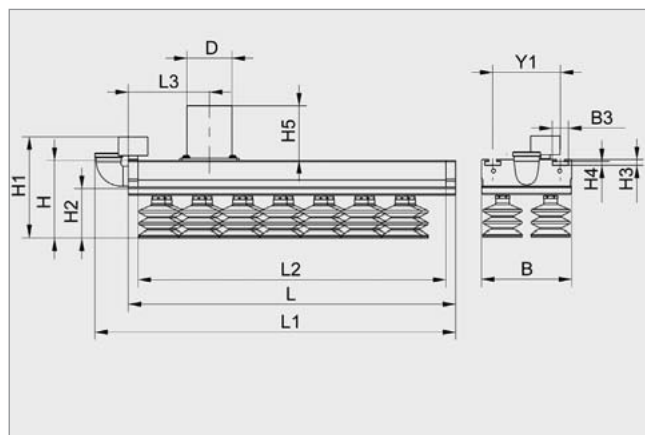

FMC

Type	Dimensions [mm]														
	B	B3	D	H	H1	H2*	H3	H4	H5	L	L1	L2	L3	Y1	N***
FXC-SW 435.5 36 FG20	122	21	-	87.5	133.5	27	7.7	5.2	-	435.5	-	409.5	27	90	44
FXC-SVKW 435.5 36 FG20	120	21	-	104	150	43.5	7.7	5.2	-	435.5	-	409.5	27	90	44
FXC-SW/SVKW 435.5 54 FG32	120	21	-	120.5	166.5	60	7.7	5.2	-	435.5	-	409.5	27	90	28
FXC-SW/SVKW 435.5 54 FG52	120	21	-	126.5	172.5	66	7.7	5.2	-	435.5	-	409.5	27	90	14
FXC-SW 633.5 36 FG20	122	21	-	87.5	133.5	27	7.7	5.2	-	633.5	-	607.5	27	90	68
FXC-SVKW 633.5 36 FG20	120	21	-	104	150	43.5	7.7	5.2	-	633.5	-	607.5	27	90	68
FXC-SW/SVKW 633.5 54 FG32	120	21	-	120.5	166.5	60	7.7	5.2	-	633.5	-	607.5	27	90	44
FXC-SW/SVKW 633.5 54 FG52	120	21	-	126.5	172.5	66	7.7	5.2	-	633.5	-	607.5	27	90	22
FXC-SW 831.5 36 FG20	122	21	-	87.5	133.5	27	7.7	5.2	-	831.5	-	805.5	27	90	90
FXC-SVKW 831.5 36 FG20	120	21	-	104	150	43.5	7.7	5.2	-	831.5	-	805.5	27	90	90
FXC-SW/SVKW 831.5 54 FG32	120	21	-	120.5	166.5	60	7.7	5.2	-	831.5	-	805.5	27	90	58
FXC-SW/SVKW 831.5 54 FG52	120	21	-	126.5	172.5	66	7.7	5.2	-	831.5	-	805.5	27	90	30
FXC-SW 1227.5 36 FG20	122	21	-	87.5	133.5	27	7.7	5.2	-	1227.5	-	1201.5	27	90	132
FXC-SVKW 1227.5 36 FG20	120	21	-	104	150	43.5	7.7	5.2	-	1227.5	-	1201.5	27	90	132
FXC-SW/SVKW 1227.5 54 FG32	120	21	-	120.5	166.5	60	7.7	5.2	-	1227.5	-	1201.5	27	90	88
FXC-SW/SVKW 1227.5 54 FG52	120	21	-	126.5	172.5	66	7.7	5.2	-	1227.5	-	1201.5	27	90	44
FMC-SW 435.5 36 FG20**	122	21	3/4"-IG	64	110	27	7.7	5.2	-	435.5	479.5	409.5	-	90	44
FMC-SVKW 435.5 36 FG20**	120	21	3/4"-IG	80.5	126.5	43.5	7.7	5.2	-	435.5	479.5	409.5	-	90	44
FMC-SW/SVKW 435.5 54 FG32**	120	21	3/4"-IG	97	143	60	7.7	5.2	-	435.5	479.5	409.5	-	90	28
FMC-SW/SVKW 435.5 54 FG52**	120	21	3/4"-IG	103	149	66	7.7	5.2	-	435.5	479.5	409.5	-	90	14
FMC-SW 633.5 36 FG20	122	21	1 1/4"-AG	64	110	27	7.7	5.2	36	633.5	633.5	607.5	103	90	68
FMC-SVKW 633.5 36 FG20	120	21	1 1/4"-AG	80.5	126.5	43.5	7.7	5.2	36	633.5	633.5	607.5	103	90	68
FMC-SW/SVKW 633.5 54 FG32	120	21	1 1/4"-AG	97	143	60	7.7	5.2	36	633.5	633.5	607.5	103	90	44
FMC-SW/SVKW 633.5 54 FG52	120	21	1 1/4"-AG	103	149	66	7.7	5.2	36	633.5	633.5	607.5	103	90	22
FMC-SW 831.5 36 FG20	122	21	60	64	110	27	7.7	5.2	73	831.5	831.5	805.5	103	90	90
FMC-SVKW 831.5 36 FG20	120	21	60	80.5	126.5	43.5	7.7	5.2	73	831.5	831.5	805.5	103	90	90
FMC-SW/SVKW 831.5 54 FG32	120	21	60	97	143	60	7.7	5.2	73	831.5	831.5	805.5	103	90	58
FMC-SW/SVKW 831.5 54 FG52	120	21	60	103	149	66	7.7	5.2	73	831.5	831.5	805.5	103	90	30
FMC-SW 1227.5 36 FG20	122	21	60	64	110	27	7.7	5.2	73	1227.5	1227.5	1201.5	103	90	132
FMC-SVKW 1227.5 36 FG20	120	21	60	80.5	126.5	43.5	7.7	5.2	73	1227.5	1227.5	1201.5	103	90	132
FMC-SW/SVKW 1227.5 54 FG32	120	21	60	97	143	60	7.7	5.2	73	1227.5	1227.5	1201.5	103	90	88
FMC-SW/SVKW 1227.5 54 FG52	120	21	60	103	149	66	7.7	5.2	73	1227.5	1227.5	1201.5	103	90	44

\*Other types of suction pads (design, material) on request

\*\*With side connection piece

\*\*\*Number of suction pads

Note: Type FXC requires compressed-air hose 8/6 mm, type FMC requires vacuum hose (dimension, D). Customer-specific gripper solutions on request.