

Bellows suction cup (round)

SAB 100 NBR-60 M16-AG

Part no.: 10.01.06.03640

<https://www.schmalz.com/10.01.06.03640>

Home > Vacuum Technology for Automation > Vacuum Components > Vacuum Suction Cups > Bellows Suction Cups (Round) > Bellows Suction Cups SAB (1.5 Folds) > SAB 100 NBR-60 M16-AG

Bellows suction cup (round) for very dynamic handling of smooth and oily workpieces



Size: 100

Suction cup material: Nitrile rubber NBR

Material hardness [Shore A]: 60 Shore A

Nipple material: Aluminum

Connection: M16-AG

Number of folds: 1.5

Design Data

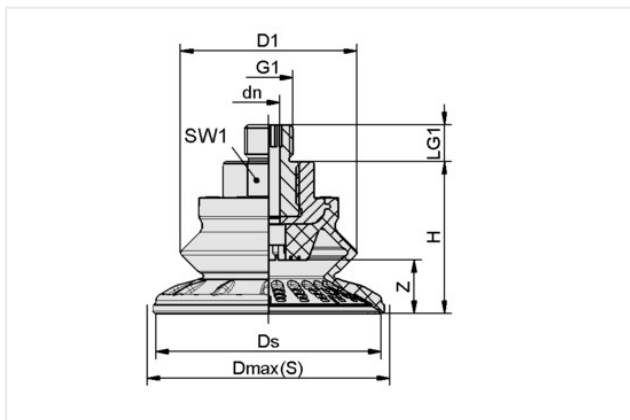

Attribute	Value
dn	6 mm
D1	77 mm
Dmax(S)	110 mm
Ds	100.80 mm
G1	M16-M
H	56.60 mm
LG1	10 mm
SW1	22 mm
Z (Stroke)	25.80 mm

Note: Acceptable dimensional tolerances for elastomer parts concerning to DIN ISO 3302-1 M3

Technical Data

Attribute	Value
Suction force (-600mbar)	190 N
Pull-off force	357 N
Lateral force	295 N
Lateral force (oily surface)	214 N
Volume	115 cm ³
Curve radius (min) (convex)	90 mm
Hose diameter (rec.) d	6 mm

Contact Schmalz

Schmalz GmbH | Commerz Park West 1, 4061 Pasching, Austria | +43 7229 24 24 4 | schmalz@schmalz.at

Bellows suction cup (round)

SAB 100 NBR-60 M16-AG

Part no...:10.01.06.03640

<https://www.schmalz.com/10.01.06.03640>

Size	100
Suction cup material	Nitrile rubber NBR
Material hardness [Shore A]	60 Shore A
Weight	111.60 g
Product family	SAB
Number of folds	1.50

Note: Suction force: The specified suction forces are theoretical values at a vacuum of -0.6 bar and with a dry, smooth and flat workpiece surface - they do not include a safety factor Lateral force: The specified lateral forces are values measured at a vacuum of -0.6 bar with a dry or oily, smooth, flat workpiece surface. Depending on the workpiece surface and its quality, the actual values may deviate from these values Hose diameter: The recommended hose diameter refers to a hose length of approx. 2 m
