

Bellows suction cup (oval)

SAOB 110x55 HT1-60 G1/4-AG

Part no.:10.01.06.03206

<https://www.schmalz.com/10.01.06.03206>

Home > Vacuum Technology for Automation > Vacuum Components > Vacuum Suction Cups > Suction Cups for Handling Glass > Bellows Suction Cups SAOB HT1 (Oval, 1.5 Folds) > SAOB 110x55 HT1-60 G1/4-AG

Bellows suction cup (oval) for high dynamic on curved, oily surfaced workpieces



Dimensions (LxB): 110 x 55

Suction cup material: High temperature material HT1

Material hardness [Shore A]: 60 Shore A

Nipple material: Aluminum

Connection: G1/4-AG

Number of folds: 1.5

Design Data

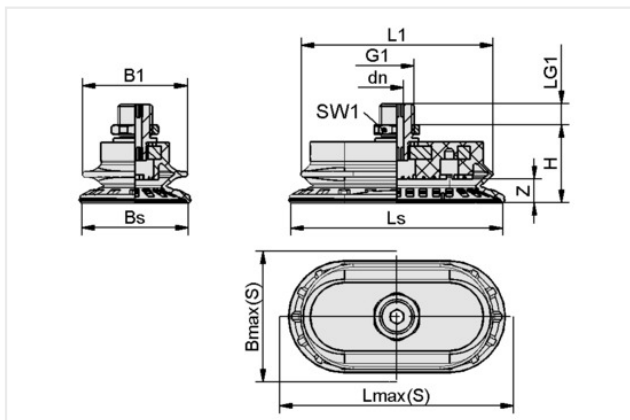

Attribute	Value
B1	53 mm
Bmax(S)	59 mm
Bs	55.10 mm
dn	6 mm
G1	G1/4"-M
H	35.50 mm
L1	98.80 mm
LG1	8 mm
Lmax(S)	114 mm
Ls	110.10 mm
SW1	17 mm
Z (Stroke)	12 mm

Note: Acceptable dimensional tolerances for elastomer parts concerning to DIN ISO 3302-1 M3

Technical Data

Attribute	Value
Suction force (-600mbar)	110 N
Pull-off force	233.50 N
Lateral force	299.20 N
Lateral force (oily surface)	123.60 N
Volume	53.10 cm ³

Contact Schmalz

Schmalz Australia Pty Ltd | 25 Turbo Drive, Bayswater North, VIC, 3153 Melbourne, Australia | +61 3 9215 8800 | schmalz@schmalz.com.au

Bellows suction cup (oval)

SAOB 110x55 HT1-60 G1/4-AG

Part no.:10.01.06.03206

<https://www.schmalz.com/10.01.06.03206>

Curve radius (min) (convex)	50 mm
Hose diameter (rec.) d	6 mm
Dimensions (LxB)	110 x 55
Number of folds	1.50
Suction cup material	High temperature material HT1
Material hardness [Shore A]	60 Shore A
Weight	79.70 g
Product family	SAOB

Note: Suction force: The specified suction forces are theoretical values at a vacuum of -0.6 bar and with a dry, smooth and flat workpiece surface - they do not include a safety factor Lateral force: The specified lateral forces are values measured at a vacuum of -0.6 bar with a dry or oily, smooth, flat workpiece surface. Depending on the workpiece surface and its quality, the actual values may deviate from these values Hose diameter: The recommended hose diameter refers to a hose length of approx. 2 m