

Flat suction cup (round)

PFYN 15 SI-CO-55 G1/8-IG

Part no.:10.01.01.10362

<https://www.schmalz.com/10.01.01.10362>

Home > Vacuum Technology for Automation > Vacuum Components > Vacuum Suction Cups > Flat Suction Cups (Round) > Flat Suction Cups PFYN > PFYN 15 SI-CO-55 G1/8-IG

Flat suction cup (round) for smooth or slightly rough surfaces



Size: 15

Suction cup material: Silicone SI conductive

Material hardness [Shore A]: 55 Shore A

Nipple material: Aluminum

Vacuum connection: G1/8"-F

Design Data

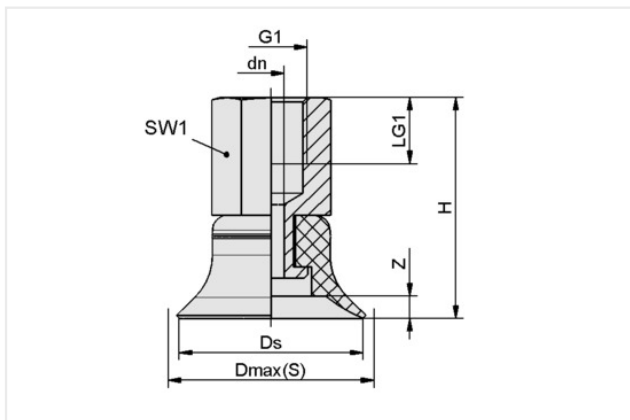

Attribute	Value
dn	2 mm
Dmax(S)	17.50 mm
Ds	15 mm
G1	G1/8"-F
H	24 mm
LG1	9 mm
SW1	14 mm
Z (Stroke)	1.90 mm

Note: Acceptable dimensional tolerances for elastomer parts concerning to DIN ISO 3302-1 M3

Technical Data

Attribute	Value
Suction force (-600mbar)	9 N
Volume	0.40 cm ³
Curve radius (min) (convex)	12.50 mm
Hose diameter (rec.) d	4 mm
Size	15
Suction cup material	Silicone SI conductive
Material hardness [Shore A]	55 Shore A

Contact Schmalz

Schmalz Australia Pty Ltd | 25 Turbo Drive, Bayswater North, VIC, 3153 Melbourne, Australia | +61 3 9215 8800 | schmalz@schmalz.com.au

Flat suction cup (round)

PFYN 15 SI-CO-55 G1/8-IG

Part no.:10.01.01.10362

<https://www.schmalz.com/10.01.01.10362>

Weight	5.80 g
Product family	PFYN
Number of folds	0

Note: Suction force: The specified suction forces are theoretical values at a vacuum of -0.6 bar and with a dry, smooth and flat workpiece surface - they do not include a safety factor
Hose diameter: The recommended hose diameter refers to a hose length of approx. 2 m

Spare parts



SA-NIP N005 G1/8-IG DN200

Part no.:10.01.01.03521

Nipple family: N 005

Thread G1: G1/8"-F

Length L1: 20.5 mm

Length L: 16 mm

Fitting length: 16 mm

Nominal diameter dn: 2 mm

Material: Aluminum



PFG 15 SI-CO-55 N005

Part no.:10.01.01.00627

Size: 15

Suction cup material: Silicone SI conductive

Material hardness [Shore A]: 55 Shore A

Contact Schmalz

Schmalz Australia Pty Ltd | 25 Turbo Drive, Bayswater North, VIC, 3153 Melbourne, Australia | +61 3 9215 8800 | schmalz@schmalz.com.au