

Flat suction cup (round)

SGPN 40 NK-40 G1/4-IG

Part no.:10.01.01.00794

<https://www.schmalz.com/10.01.01.00794>

Home > Vacuum Technology for Automation > Vacuum Components > Vacuum Suction Cups > Suction Cups for Plastic Films and Paper > Flat Suction Cups SGPN > SGPN 40 NK-40 G1/4-IG

Flat suction cup (round) for careful gripping of paper, plastic film, etc.



Size: 40

Suction cup material: Natural Rubber NK

Material hardness [Shore A]: 40 Shore A

Nipple material: Aluminum

Vacuum connection: G1/4"-F

Design Data

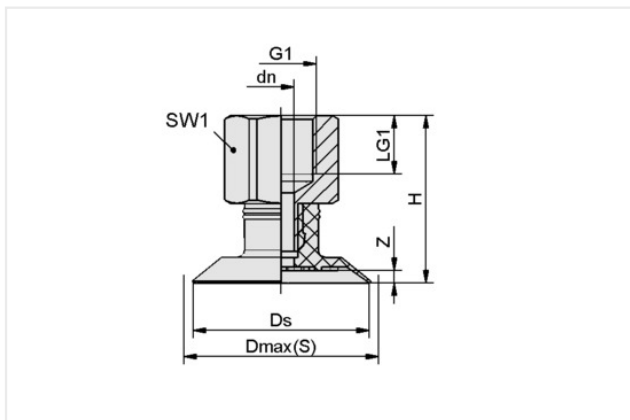

| Attribute | Value |
|------------|----------|
| dn | 5 mm |
| Dmax(S) | 42 mm |
| Ds | 40 mm |
| G1 | G1/4"-F |
| H | 35.60 mm |
| LG1 | 12 mm |
| SW1 | 17 mm |
| Z (Stroke) | 2.30 mm |

Note: Acceptable dimensional tolerances for elastomer parts concerning to DIN ISO 3302-1 M3

Technical Data

| Attribute | Value |
|-----------------------------|----------------------|
| Suction force (-600mbar) | 33 N |
| Volume | 3.80 cm ³ |
| Hose diameter (rec.) d | 4 mm |
| Size | 40 |
| Number of folds | 0 |
| Suction cup material | Natural Rubber NK |
| Material hardness [Shore A] | 40 Shore A |

Contact Schmalz

Schmalz Australia Pty Ltd | 25 Turbo Drive, Bayswater North, VIC, 3153 Melbourne, Australia | +61 3 9215 8800 | schmalz@schmalz.com.au

Flat suction cup (round)

SGPN 40 NK-40 G1/4-IG

Part no.:10.01.01.00794

<https://www.schmalz.com/10.01.01.00794>

| | |
|----------------|---------|
| Weight | 13.10 g |
| Product family | SGPN |

Note: Suction force: The specified suction forces are theoretical values at a vacuum of -0.6 bar and with a dry, smooth and flat workpiece surface - they do not include a safety factor
Hose diameter: The recommended hose diameter refers to a hose length of approx. 2 m

Spare parts



SA-NIP N035 G1/4-IG DN550

Part no.:10.01.01.00821

Thread G1: G1/4"-F

Fitting length: 15 mm

Material: Aluminum

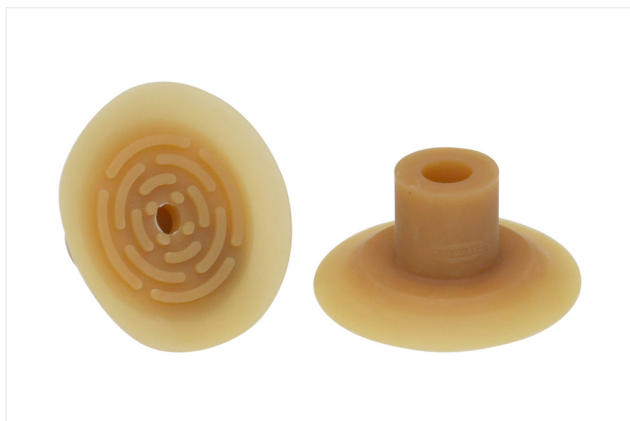

SGP 40 NK-40 N035

Part no.:10.01.01.00789

Size: 40

Suction cup material: Natural Rubber NK

Material hardness [Shore A]: 40 Shore A

Contact Schmalz

Schmalz Australia Pty Ltd | 25 Turbo Drive, Bayswater North, VIC, 3153 Melbourne, Australia | +61 3 9215 8800 | schmalz@schmalz.com.au