

Bellows suction cup (round)

SAB 50 NBR-60 G1/4-IG

Part no.:10.01.06.00851

<https://www.schmalz.com/10.01.06.00851>

Home > Vacuum Technology for Automation > Vacuum Components > Vacuum Suction Cups > Bellows Suction Cups (Round) > Bellows Suction Cups SAB (1.5 Folds) > SAB 50 NBR-60 G1/4-IG

Bellows suction cup (round) for very dynamic handling of smooth and oily workpieces



Size: 50

Suction cup material: Nitrile rubber NBR

Material hardness [Shore A]: 60 Shore A

Nipple material: Nickel plated

Connection: G1/4-IG

Number of folds: 1.5

Design Data

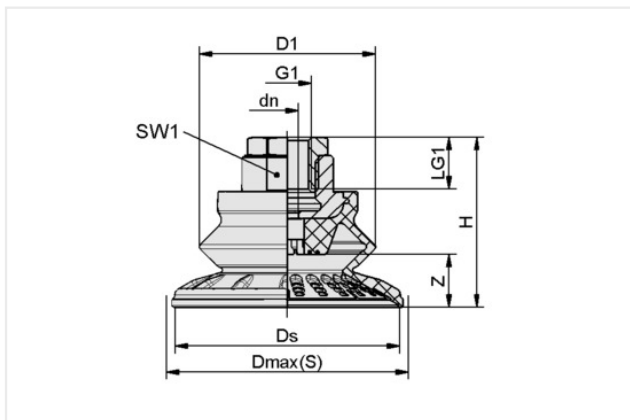

| Attribute | Value |
|------------|----------|
| dn | 6 mm |
| D1 | 39.50 mm |
| Dmax(S) | 56 mm |
| Ds | 50.10 mm |
| G1 | G1/4"-F |
| H | 42 mm |
| LG1 | 20 mm |
| SW1 | 22 mm |
| Z (Stroke) | 11.50 mm |

Note: Acceptable dimensional tolerances for elastomer parts concerning to DIN ISO 3302-1 M3

Technical Data

| Attribute | Value |
|------------------------------|-----------------------|
| Suction force (-600mbar) | 53 N |
| Pull-off force | 87 N |
| Lateral force | 95 N |
| Lateral force (oily surface) | 52 N |
| Volume | 16.10 cm ³ |
| Curve radius (min) (convex) | 50 mm |
| Hose diameter (rec.) d | 4 mm |

Contact Schmalz

Schmalz India Pvt. Ltd. | EL - 38 J Block MIDC, 411 026 Bhosari, Pune, India | +91 20 691155-00 | schmalz@schmalz.co.in

Bellows suction cup (round)

SAB 50 NBR-60 G1/4-IG

Part no.:10.01.06.00851

<https://www.schmalz.com/10.01.06.00851>

| | |
|-----------------------------|--------------------|
| Size | 50 |
| Suction cup material | Nitrile rubber NBR |
| Material hardness [Shore A] | 60 Shore A |
| Weight | 45.20 g |
| Product family | SAB |
| Number of folds | 1.50 |

Note: Suction force: The specified suction forces are theoretical values at a vacuum of -0.6 bar and with a dry, smooth and flat workpiece surface - they do not include a safety factor Lateral force: The specified lateral forces are values measured at a vacuum of -0.6 bar with a dry or oily, smooth, flat workpiece surface. Depending on the workpiece surface and its quality, the actual values may deviate from these values Hose diameter: The recommended hose diameter refers to a hose length of approx. 2 m
