

## Bellows suction cup (round)

SAB 80 NBR-60 G1/4-AG

Part no.:10.01.06.00806

<https://www.schmalz.com/10.01.06.00806>

Home > Vacuum Technology for Automation > Vacuum Components > Vacuum Suction Cups > Bellows Suction Cups (Round) > Bellows Suction Cups SAB (1.5 Folds) > SAB 80 NBR-60 G1/4-AG

### Bellows suction cup (round) for very dynamic handling of smooth and oily workpieces



Size: 80

Suction cup material: Nitrile rubber NBR

Material hardness [Shore A]: 60 Shore A

Nipple material: Aluminum

Connection: G1/4-AG

Number of folds: 1.5

### Design Data

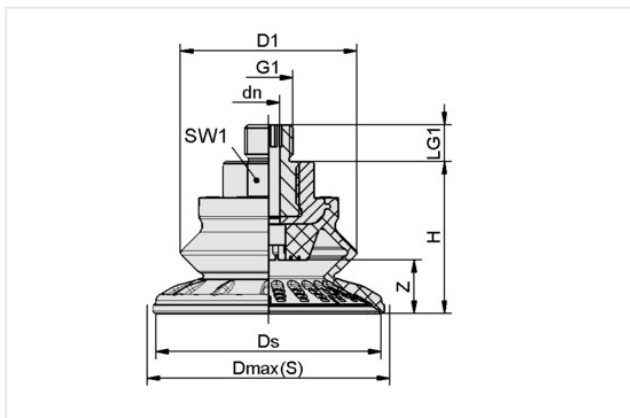

Attribute	Value
dn	6 mm
D1	63.60 mm
Dmax(S)	89 mm
Ds	81.10 mm
G1	G1/4"-M
H	49.90 mm
LG1	10 mm
SW1	22 mm
Z (Stroke)	22.10 mm

Note: Acceptable dimensional tolerances for elastomer parts concerning to DIN ISO 3302-1 M3

### Technical Data

Attribute	Value
Suction force (-600mbar)	135 N
Pull-off force	221 N
Lateral force	205 N
Lateral force (oily surface)	140 N
Volume	67.60 cm <sup>3</sup>
Curve radius (min) (convex)	75 mm
Hose diameter (rec.) d	6 mm

### Contact Schmalz

Schmalz S.r.l. a Socio Unico | Via Ticino 105, 28066 Galliate (NO), Italy | +39 0321 62 15 10 | [schmalz@schmalz.it](mailto:schmalz@schmalz.it)

## Bellows suction cup (round)

SAB 80 NBR-60 G1/4-AG

Part no...:10.01.06.00806

<https://www.schmalz.com/10.01.06.00806>

Size	80
Suction cup material	Nitrile rubber NBR
Material hardness [Shore A]	60 Shore A
Weight	72.10 g
Product family	SAB
Number of folds	1.50

Note: Suction force: The specified suction forces are theoretical values at a vacuum of -0.6 bar and with a dry, smooth and flat workpiece surface - they do not include a safety factor Lateral force: The specified lateral forces are values measured at a vacuum of -0.6 bar with a dry or oily, smooth, flat workpiece surface. Depending on the workpiece surface and its quality, the actual values may deviate from these values Hose diameter: The recommended hose diameter refers to a hose length of approx. 2 m

---