

## Bellows suction cup (round)

SAB 50 NBR-60 G1/4-IG

Part no.:10.01.06.00851

<https://www.schmalz.com/10.01.06.00851>

Home > Vacuum Technology for Automation > Vacuum Components > Vacuum Suction Cups > Bellows Suction Cups (Round) > Bellows Suction Cups SAB (1.5 Folds) > SAB 50 NBR-60 G1/4-IG

### Bellows suction cup (round) for very dynamic handling of smooth and oily workpieces



Size: 50

Suction cup material: Nitrile rubber NBR

Material hardness [Shore A]: 60 Shore A

Nipple material: Nickel plated

Connection: G1/4-IG

Number of folds: 1.5

### Design Data

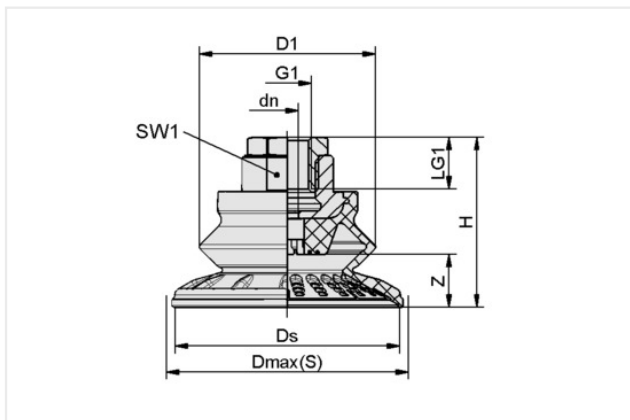

Attribute	Value
dn	6 mm
D1	39.50 mm
Dmax(S)	56 mm
Ds	50.10 mm
G1	G1/4"-F
H	42 mm
LG1	20 mm
SW1	22 mm
Z (Stroke)	11.50 mm

Note: Acceptable dimensional tolerances for elastomer parts concerning to DIN ISO 3302-1 M3

### Technical Data

Attribute	Value
Suction force (-600mbar)	53 N
Pull-off force	87 N
Lateral force	95 N
Lateral force (oily surface)	52 N
Volume	16.10 cm <sup>3</sup>
Curve radius (min) (convex)	50 mm
Hose diameter (rec.) d	4 mm

### Contact Schmalz

Schmalz S.r.l. a Socio Unico | Via Ticino 105, 28066 Galliate (NO), Italy | +39 0321 62 15 10 | [schmalz@schmalz.it](mailto:schmalz@schmalz.it)

## Bellows suction cup (round)

SAB 50 NBR-60 G1/4-IG

Part no.:10.01.06.00851

<https://www.schmalz.com/10.01.06.00851>

Size	50
Suction cup material	Nitrile rubber NBR
Material hardness [Shore A]	60 Shore A
Weight	45.20 g
Product family	SAB
Number of folds	1.50

Note: Suction force: The specified suction forces are theoretical values at a vacuum of -0.6 bar and with a dry, smooth and flat workpiece surface - they do not include a safety factor Lateral force: The specified lateral forces are values measured at a vacuum of -0.6 bar with a dry or oily, smooth, flat workpiece surface. Depending on the workpiece surface and its quality, the actual values may deviate from these values Hose diameter: The recommended hose diameter refers to a hose length of approx. 2 m

---