

Bellows suction cup (round)

SAB 22 NBR-60 RA

Part no.:10.01.06.01663

<https://www.schmalz.com/10.01.06.01663>

Home > Vacuum Technology for Automation > Vacuum Components > Vacuum Suction Cups > Bellows Suction Cups (Round) > Bellows Suction Cups SAB (1.5 Folds) > SAB 22 NBR-60 RA

Bellows suction cup (round) for very dynamic handling of smooth and oily workpieces



Size: 22

Suction cup material: Nitrile rubber NBR

Material hardness [Shore A]: 60 Shore A

Nipple material: Aluminum

Connection: RA

Number of folds: 1.5

Design Data

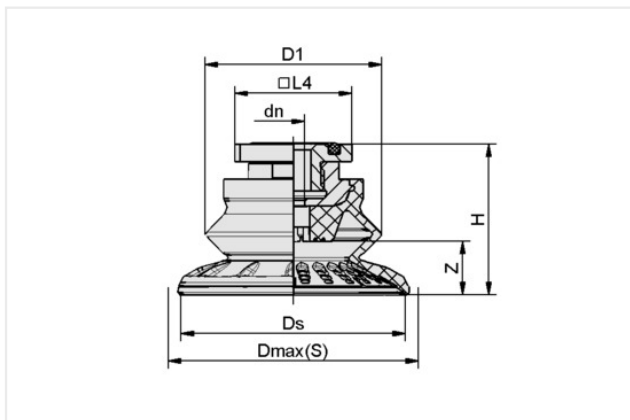

Attribute	Value
dn	3.50 mm
D1	22 mm
Dmax(S)	24 mm
Ds	20.60 mm
H	28.20 mm
L4	31.80 mm
Z (Stroke)	5.80 mm

Note: Acceptable dimensional tolerances for elastomer parts concerning to DIN ISO 3302-1 M3

Technical Data

Attribute	Value
Suction force (-600mbar)	16 N
Pull-off force	24 N
Lateral force	18 N
Lateral force (oily surface)	6 N
Volume	2.48 cm ³
Curve radius (min) (convex)	20 mm
Hose diameter (rec.) d	4 mm

Contact Schmalz

Schmalz S.r.l. a Socio Unico | Via Ticino 105, 28066 Galliate (NO), Italy | +39 0321 62 15 10 | schmalz@schmalz.it

Bellows suction cup (round)

SAB 22 NBR-60 RA

Part no...:10.01.06.01663

<https://www.schmalz.com/10.01.06.01663>

Size	22
Suction cup material	Nitrile rubber NBR
Material hardness [Shore A]	60 Shore A
Weight	11 g
Product family	SAB
Number of folds	1.50

Note: Suction force: The specified suction forces are theoretical values at a vacuum of -0.6 bar and with a dry, smooth and flat workpiece surface - they do not include a safety factor Lateral force: The specified lateral forces are values measured at a vacuum of -0.6 bar with a dry or oily, smooth, flat workpiece surface. Depending on the workpiece surface and its quality, the actual values may deviate from these values Hose diameter: The recommended hose diameter refers to a hose length of approx. 2 m
