

## Bellows suction cup (round)

SAB 50 NBR-60 G1/4-IG

Part no.:10.01.06.00851

<https://www.schmalz.com/10.01.06.00851>

Home > Vacuum Technology for Automation > Vacuum Components > Vacuum Suction Cups > Bellows Suction Cups (Round) > Bellows Suction Cups SAB (1.5 Folds) > SAB 50 NBR-60 G1/4-IG

### Bellows suction cup (round) for very dynamic handling of smooth and oily workpieces



Size: 50

Suction cup material: Nitrile rubber NBR

Material hardness [Shore A]: 60 Shore A

Nipple material: Nickel plated

Connection: G1/4-IG

Number of folds: 1.5

### Design Data

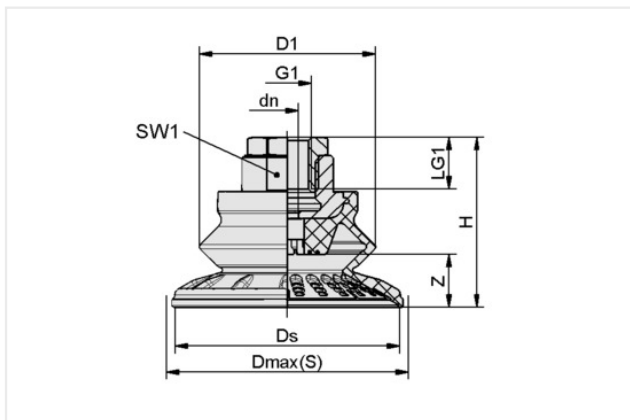

| Attribute  | Value    |
|------------|----------|
| dn         | 6 mm     |
| D1         | 39.50 mm |
| Dmax(S)    | 56 mm    |
| Ds         | 50.10 mm |
| G1         | G1/4"-F  |
| H          | 42 mm    |
| LG1        | 20 mm    |
| SW1        | 22 mm    |
| Z (Stroke) | 11.50 mm |

Note: Acceptable dimensional tolerances for elastomer parts concerning to DIN ISO 3302-1 M3

### Technical Data

| Attribute                    | Value                 |
|------------------------------|-----------------------|
| Suction force (-600mbar)     | 53 N                  |
| Pull-off force               | 87 N                  |
| Lateral force                | 95 N                  |
| Lateral force (oily surface) | 52 N                  |
| Volume                       | 16.10 cm <sup>3</sup> |
| Curve radius (min) (convex)  | 50 mm                 |
| Hose diameter (rec.) d       | 4 mm                  |

### Contact Schmalz

Schmalz d.o.o. | Velika Ligojna 4, Vrhnika, Slovenia | +386 70 613 796 | [info@schmalz.si](mailto:info@schmalz.si)

## Bellows suction cup (round)

SAB 50 NBR-60 G1/4-IG

Part no.:10.01.06.00851

<https://www.schmalz.com/10.01.06.00851>

|                             |                    |
|-----------------------------|--------------------|
| Size                        | 50                 |
| Suction cup material        | Nitrile rubber NBR |
| Material hardness [Shore A] | 60 Shore A         |
| Weight                      | 45.20 g            |
| Product family              | SAB                |
| Number of folds             | 1.50               |

Note: Suction force: The specified suction forces are theoretical values at a vacuum of -0.6 bar and with a dry, smooth and flat workpiece surface - they do not include a safety factor Lateral force: The specified lateral forces are values measured at a vacuum of -0.6 bar with a dry or oily, smooth, flat workpiece surface. Depending on the workpiece surface and its quality, the actual values may deviate from these values Hose diameter: The recommended hose diameter refers to a hose length of approx. 2 m