

Plug union, straight

STV-GE G1/8-AG 6

Part no.:10.08.02.00204

<https://www.schmalz.com/10.08.02.00204>

Homepage > Vacuum Technology for Automation > Vacuum Components > Filters and Connections > Hoses and Connectors > Screw in Push Fittings > STV-GE G1/8-AG 6

Push-in Fitting, straight



Thread G1: G1/8"-M
 External hose diameter: 6 mm
 Material: Brass
 Surface: nickel plated
 Ambient temperature: -20 ... 80 °C

Design Data

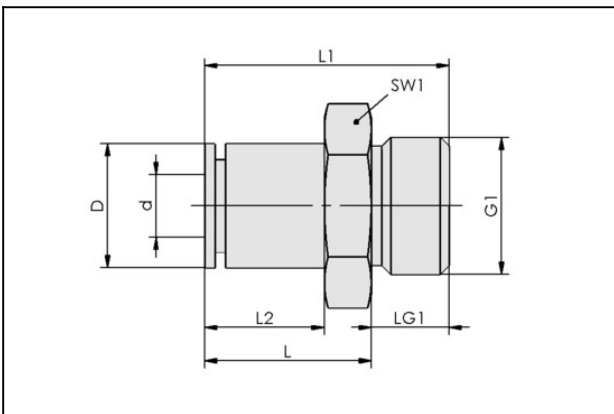

Attribute	Value
D	11.4 mm
d	6 mm
G1	G1/8"-M
dn	4 mm
L	16.4 mm
L1	21.9 mm
L2	12.1 mm
LG1	5.5 mm
SW1	13 mm

Technical Data

Plug union, straight

STV-GE G1/8-AG 6

Part no.:10.08.02.00204

<https://www.schmalz.com/10.08.02.00204>



Attribute	Value
Hose type	Hose D = 6 d = 4
Hose type	6-4
Material	Brass
Pressure range (operating pressure)	-0,95 ... 15,00 bar
Operating temperature	-20 ... 80 °C
Weight	11 g

Accessories

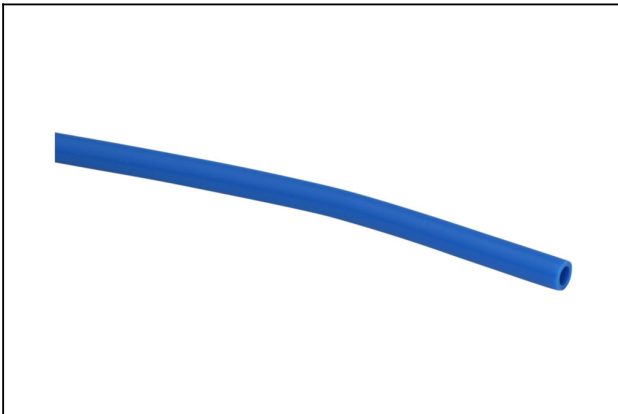

VSL 6-4 PE

Part no.10.07.09.00014

Hose for vacuum and compressed-air systems

External diameter D: 6 mm

Internal diameter d: 4 mm

Length (max): 100 m

Material: PE

Installation radius (min): 35 mm

Pressure range (operating pressure):

-0.95 ... 10.00 bar

Ambient temperature: -30 ... 70 °C



VSL 6-4 PTFE

Part no.10.07.09.00157

Hose for vacuum and compressed-air systems

External diameter D: 6 mm

Internal diameter d: 4 mm

Length (max): 50 m

Material: Polytetrafluorethylene

Installation radius (min): 35 mm

Colour: natur

Pressure range (operating pressure):

-0.95 ... 10.00 bar

Ambient temperature: -190 ... 260 °C

Plug union, straight

STV-GE G1/8-AG 6

Part no.:10.08.02.00204

<https://www.schmalz.com/10.08.02.00204>



VSL 6-4 PU

Part no.10.07.09.00002

Hose for vacuum and compressed-air systems

External diameter D: 6 mm

Internal diameter d: 4 mm

Length (max): 500 m

Material: PU

Installation radius (min): 35 mm

Pressure range (operating pressure):

-0.95 ... 10.00 bar

Ambient temperature: -20 ... 90 °C